

## SPECIAL OFFER



### Planerhead VariPlan

**Machine:**  
Four side planer

**Material:**  
Soft- and hardwood

**Technical information:**  
Aluminium planerhead with resharpenable HS or HW reversible resharpenable knives positioned by form-locking knife clamping system.

**Speciality:**  
The VariPlan clamping system clamps new and resharpened knives in position automatically to a constant cutting circle.  
As the clamping wedge is positioned behind the cutting edge the wedge is protected from dirt. Reduced noise level from the closed design.

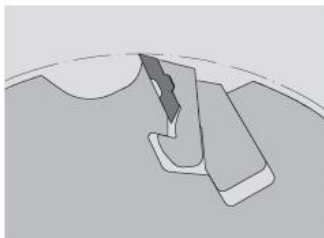
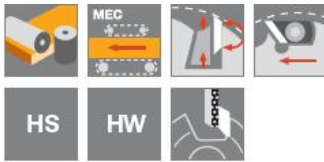

Aluminium cutterhead with separate steel chip breaker.

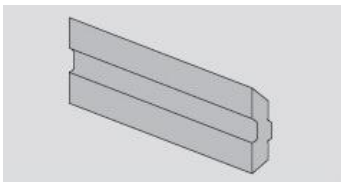

Resharpenable HS- and HW- turnblade knives

**Our part no.:** 057-839-00  
VariPlan-A.Planerhead WW 240 2 05  
HW: 125x270/276x40, Z2 SPST2,5

**LIST PRICE: EUR 1.262,00**

**SPECIAL NET PRICE: EUR 529,00**

**Delivery time: ex stock / WHILE STOCKS LAST!!!**